

P-Channel 30 V (D-S) MOSFET



RoHS
COMPLIANT

PRODUCT SUMMARY

| V _{DS} (V) | R _{DS(on)} (Ω) Max. | I _D (A) | Q _g (Typ.) |
|---------------------|-------------------------------------|--------------------|-----------------------|
| - 30 | 0.0123 at V _{GS} = - 10 V | - 45 ^d | 40 nC |
| | 0.0179 at V _{GS} = - 4.5 V | - 30 ^d | |

FEATURES

- DT-Trench Power MOSFET
- Low On-Resistance for Low Voltage Drop
- 100 % R_g and UIS Tested

APPLICATIONS

- Battery, Load and Adaptor Switches
 - Notebook Computers
 - Notebook Battery Packs

PDFN 3.3x3.3

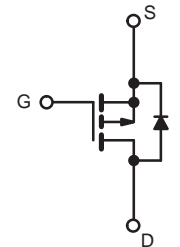
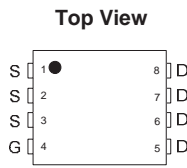
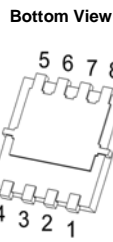
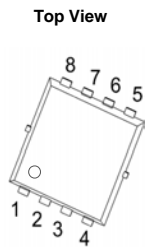

P-Channel MOSFET

ABSOLUTE MAXIMUM RATINGS (T_A = 25 °C, unless otherwise noted)

| Parameter | Symbol | Limit | Unit |
|--|-----------------------------------|------------------------|-----------------------|
| Drain-Source Voltage | V _{DS} | - 30 | V |
| Gate-Source Voltage | V _{GS} | ± 20 | |
| Continuous Drain Current (T _J = 150 °C) | I _D | T _C = 25 °C | - 45 ^d |
| | | T _C = 70 °C | - 35 ^d |
| | | T _A = 25 °C | - 18 ^{a, b} |
| | | T _A = 70 °C | - 9 ^{a, b} |
| Pulsed Drain Current (t = 100 μs) | I _{DM} | - 180 | A |
| Continuous Source-Drain Diode Current | I _S | T _C = 25 °C | - 45 ^d |
| | | T _A = 25 °C | - 3.8 ^{a, b} |
| Avalanche Current | I _{AS} | - 25 | |
| Single-Pulse Avalanche Energy | E _{AS} | 35 | mJ |
| Maximum Power Dissipation | P _D | T _C = 25 °C | 43 |
| | | T _C = 70 °C | 26 |
| | | T _A = 25 °C | 4.8 ^{a, b} |
| | | T _A = 70 °C | 3 ^{a, b} |
| Operating Junction and Storage Temperature Range | T _J , T _{stg} | - 55 to 150 | °C |
| Soldering Recommendations (Peak Temperature) ^{e, f} | | 260 | |

THERMAL RESISTANCE RATINGS

| Parameter | Symbol | Typical | Maximum | Unit |
|---|-------------------|---------|---------|------|
| Maximum Junction-to-Ambient ^{a, c} | R _{thJA} | 25 | 30 | °C/W |
| Maximum Junction-to-Case | R _{thJC} | 2.5 | 3 | |

Notes:

a. Surface mounted on 1" x 1" FR4 board.

b. t = 10 s.

c. Maximum under steady state conditions is 70 °C/W.

d. Package limited.

e. The DFN3X3 is a leadless package. The end of the lead terminal is exposed copper (not plated) as a result of the singulation process in manufacturing. A solder fillet at the exposed copper tip cannot be guaranteed and is not required to ensure adequate bottom side solder interconnection.

f. Rework conditions: manual soldering with a soldering iron is not recommended for leadless components.

| SPECIFICATIONS ($T_J = 25\text{ }^\circ\text{C}$, unless otherwise noted) | | | | | | |
|--|-------------------------|---|---|--------|-----------|---------------|
| Parameter | Symbol | Test Conditions | Min. | Typ. | Max. | Unit |
| Static | | | | | | |
| Drain-Source Breakdown Voltage | V_{DS} | $V_{GS} = 0, I_D = -250\text{ }\mu\text{A}$ | -30 | | | V |
| V_{DS} Temperature Coefficient | $\Delta V_{DS}/T_J$ | $I_D = -250\text{ }\mu\text{A}$ | | -22 | | mV/°C |
| $V_{GS(th)}$ Temperature Coefficient | $\Delta V_{GS(th)}/T_J$ | | | 4.1 | | |
| Gate-Source Threshold Voltage | $V_{GS(th)}$ | $V_{DS} = V_{GS}, I_D = -250\text{ }\mu\text{A}$ | -1 | | -3 | V |
| Gate-Source Leakage | I_{GSS} | $V_{DS} = 0\text{ V}, V_{GS} = \pm 20\text{ V}$ | | | ± 100 | nA |
| Zero Gate Voltage Drain Current | I_{DSS} | $V_{DS} = -24\text{ V}, V_{GS} = 0\text{ V}$ | | | -1 | μA |
| | | $V_{DS} = -24\text{ V}, V_{GS} = 0\text{ V}, T_J = 55\text{ }^\circ\text{C}$ | | | -5 | |
| On-State Drain Current ^a | $I_{D(on)}$ | $V_{DS} \geq -10\text{ V}, V_{GS} = -10\text{ V}$ | -180 | | | A |
| Drain-Source On-State Resistance ^a | $R_{DS(on)}$ | $V_{GS} = -10\text{ V}, I_D = -15\text{ A}$ | | 0.0123 | 0.014 | Ω |
| | | $V_{GS} = -4.5\text{ V}, I_D = -10\text{ A}$ | | 0.0179 | 0.02 | |
| Forward Transconductance ^a | g_{fs} | $V_{DS} = -10\text{ V}, I_D = -15\text{ A}$ | | 60 | | S |
| Dynamic^b | | | | | | |
| Input Capacitance | C_{iss} | $V_{DS} = -24\text{ V}, V_{GS} = 0\text{ V}, f = 1\text{ MHz}$ | | 3150 | | pF |
| Output Capacitance | C_{oss} | | | 975 | | |
| Reverse Transfer Capacitance | C_{rss} | | | 384 | | |
| Total Gate Charge | Q_g | $V_{DS} = -24\text{ V}, V_{GS} = -10\text{ V}, I_D = -10\text{ A}$ | | 92 | | nC |
| | | | $V_{DS} = -24\text{ V}, V_{GS} = -4.5\text{ V}, I_D = -10\text{ A}$ | | 41 | |
| Q_{gs} | | 14 | | | | |
| Q_{gd} | | 29 | | | | |
| Gate Resistance | R_g | $f = 1\text{ MHz}$ | 0.5 | 2.9 | 5.8 | Ω |
| Turn-On Delay Time | $t_{d(on)}$ | $V_{DS} = -15\text{ V}, R_L = 1.5\text{ }\Omega$ $I_D \cong -10\text{ A}, V_{GS} = -10\text{ V}, R_g = 1\text{ }\Omega$ | | 16 | | ns |
| Rise Time | t_r | | | 14 | | |
| Turn-Off Delay Time | $t_{d(off)}$ | | | 60 | | |
| Fall Time | t_f | | | 12 | | |
| Turn-On Delay Time | $t_{d(on)}$ | $V_{DS} = -15\text{ V}, R_L = 1.5\text{ }\Omega$ $I_D \cong -10\text{ A}, V_{GS} = -4.5\text{ V}, R_g = 1\text{ }\Omega$ | | 60 | | |
| Rise Time | t_r | | | 59 | | |
| Turn-Off Delay Time | $t_{d(off)}$ | | | 50 | | |
| Fall Time | t_f | | | 22 | | |
| Drain-Source Body Diode Characteristics | | | | | | |
| Continuous Source-Drain Diode Current | I_S | $T_C = 25\text{ }^\circ\text{C}$ | | | -45 | A |
| Pulse Diode Forward Current (100 μs) | I_{SM} | | | | -180 | |
| Body Diode Voltage | V_{SD} | $I_S = -3\text{ A}, V_{GS} = 0$ | | -0.7 | -1.20 | V |
| Body Diode Reverse Recovery Time | t_{rr} | $I_F = -10\text{ A}, dI/dt = 100\text{ A}/\mu\text{s}, T_J = 25\text{ }^\circ\text{C}$ | | 22 | | ns |
| Body Diode Reverse Recovery Charge | Q_{rr} | | | 12 | | nC |
| Reverse Recovery Fall Time | t_a | | | 9 | | ns |
| Reverse Recovery Rise Time | t_b | | | 13 | | |

Notes:

- a. Pulse test; pulse width $\leq 300\text{ }\mu\text{s}$, duty cycle $\leq 2\%$.
 b. Guaranteed by design, not subject to production testing.

Stresses beyond those listed under "Absolute Maximum Ratings" may cause permanent damage to the device. These are stress ratings only, and functional operation of the device at these or any other conditions beyond those indicated in the operational sections of the specifications is not implied. Exposure to absolute maximum rating conditions for extended periods may affect device reliability.

TYPICAL CHARACTERISTICS (25 °C, unless otherwise noted)

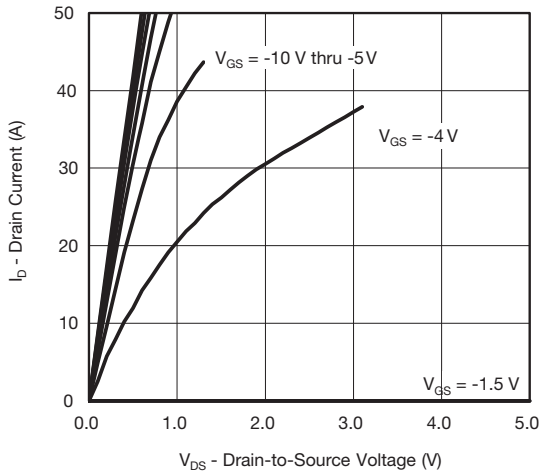

Output Characteristics

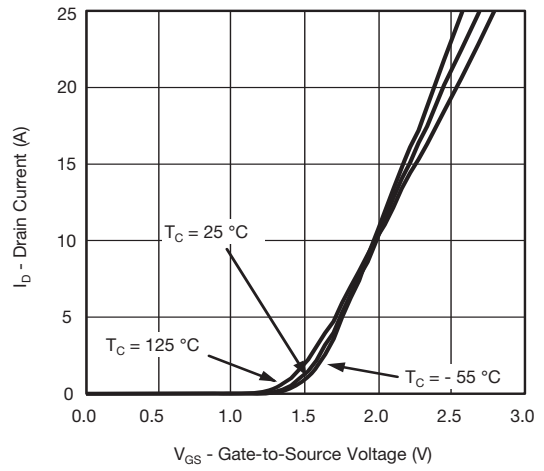

Transfer Characteristics

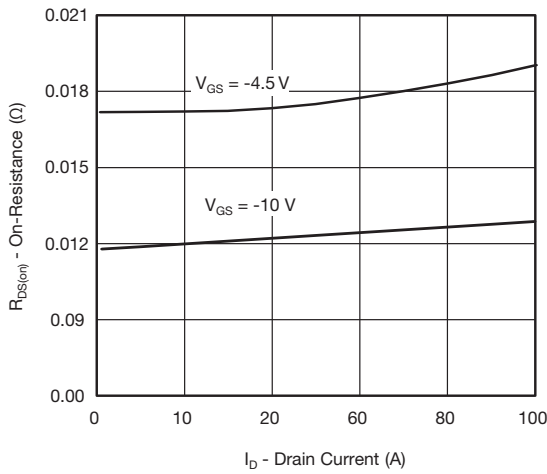

On-Resistance vs. Drain Current

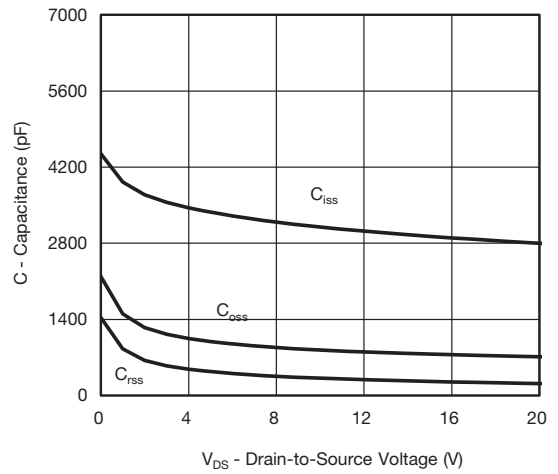

Capacitance

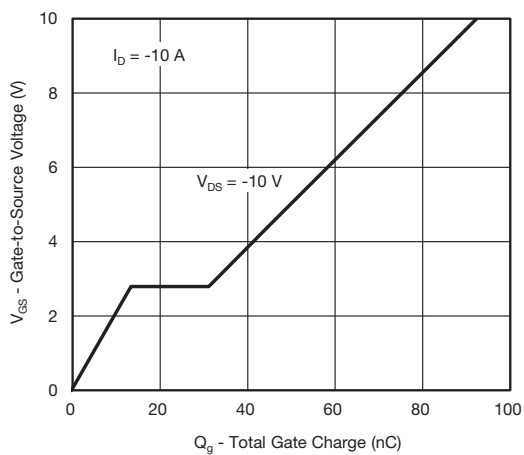

Gate Charge

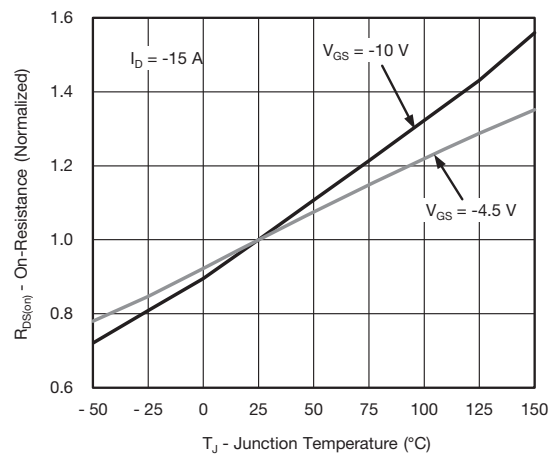

On-Resistance vs. Junction Temperature

TYPICAL CHARACTERISTICS (25 °C, unless otherwise noted)

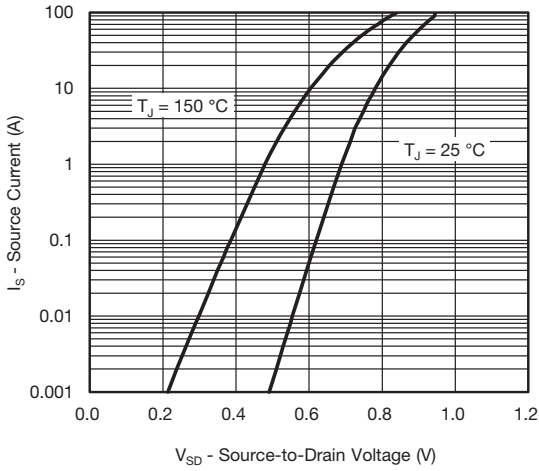

Source-Drain Diode Forward Voltage

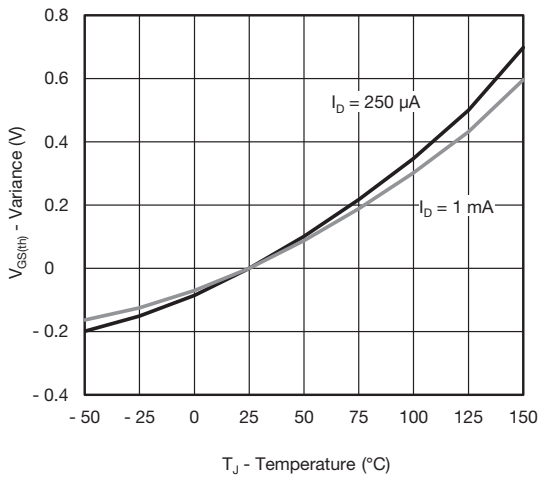

Threshold Voltage

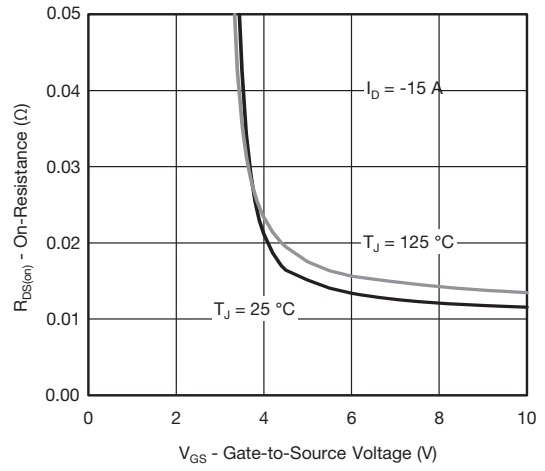

On-Resistance vs. Gate-to-Source Voltage

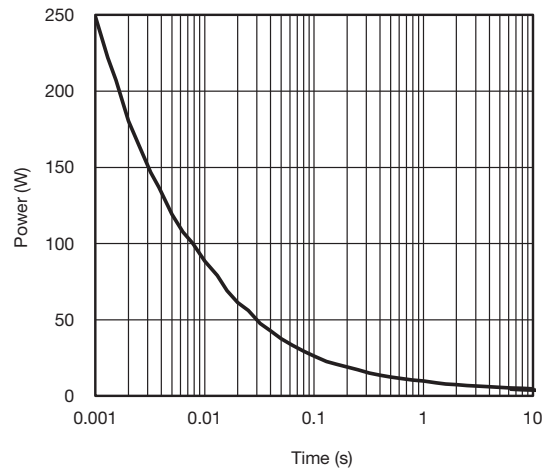

Single Pulse Power, Junction-to-Ambient

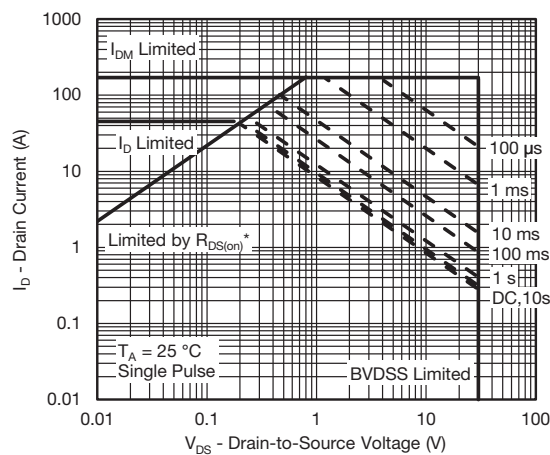

* $V_{GS} >$ minimum V_{GS} at which $R_{DS(on)}$ is specified

Safe Operating Area

TYPICAL CHARACTERISTICS (25 °C, unless otherwise noted)

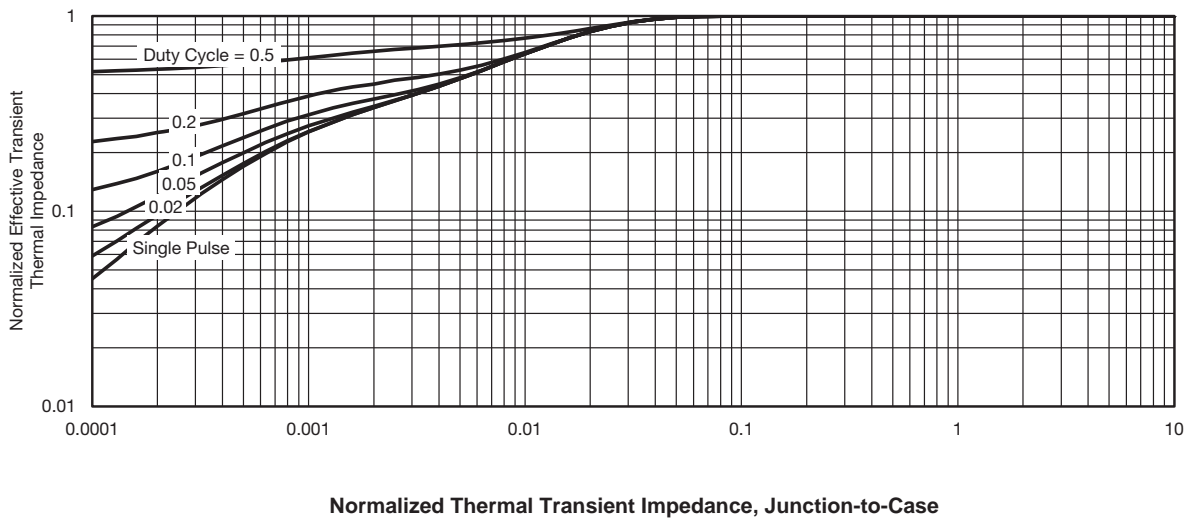
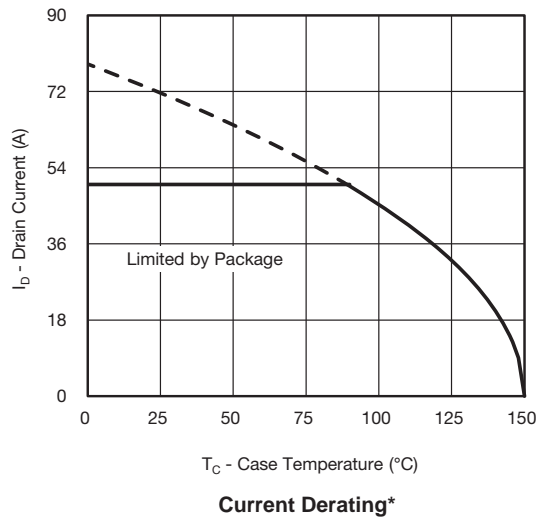

PDFN3.3*3.3-8L Case Outline

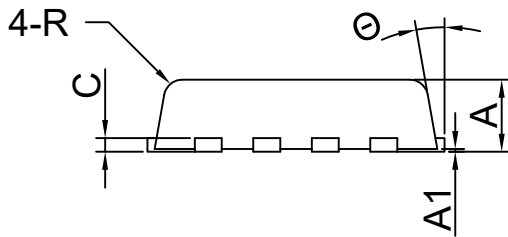
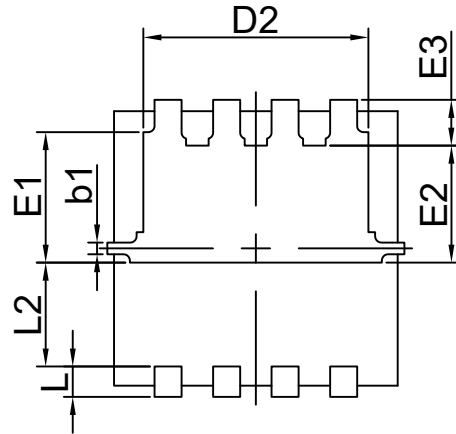
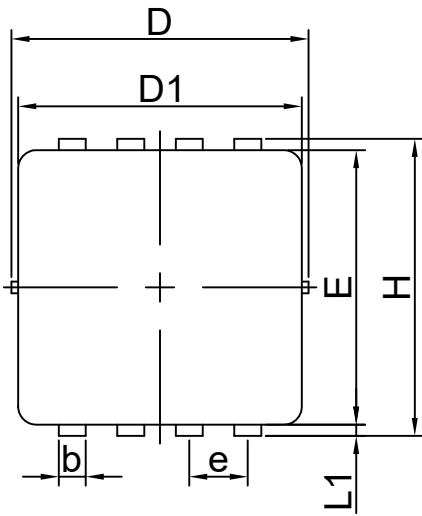

| SYMBOL | MIN | NOM | MAX |
|----------------|----------|------|------|
| A | 0.70 | 0.80 | 0.90 |
| A ₁ | 0.00 | 0.03 | 0.05 |
| b | 0.24 | 0.30 | 0.35 |
| b ₁ | 0.08 | 0.13 | 0.18 |
| c | 0.152REF | | |
| D | 3.25 | 3.32 | 3.40 |
| D ₁ | 3.05 | 3.15 | 3.25 |
| D ₂ | 2.40 | 2.50 | 2.60 |
| E | 3.00 | 3.10 | 3.20 |
| E ₁ | 1.35 | 1.45 | 1.55 |
| E ₂ | 1.20 | 1.30 | 1.40 |
| E ₃ | 0.40 | 0.50 | 0.60 |
| e | 0.65 BSC | | |
| H | 3.20 | 3.30 | 3.40 |
| L | 0.30 | 0.40 | 0.50 |
| L ₁ | 0.10 | 0.15 | 0.20 |
| L ₂ | 1.13 REF | | |
| R | 0.20 REF | | |
| Θ | 6° | 10° | 14° |

Disclaimer

ALL PRODUCT, PRODUCT SPECIFICATIONS AND DATA ARE SUBJECT TO CHANGE WITHOUT NOTICE TO IMPROVE RELIABILITY, FUNCTION OR DESIGN OR OTHERWISE.

Din-Tek Intertechnology, Inc., its affiliates, agents, and employees, and all persons acting on its or their behalf (collectively, "Din-Tek"), disclaim any and all liability for any errors, inaccuracies or incompleteness contained in any datasheet or in any other disclosure relating to any product.

Din-Tek makes no warranty, representation or guarantee regarding the suitability of the products for any particular purpose or the continuing production of any product. To the maximum extent permitted by applicable law, Din-Tek disclaims (i) any and all liability arising out of the application or use of any product, (ii) any and all liability, including without limitation special, consequential or incidental damages, and (iii) any and all implied warranties, including warranties of fitness for particular purpose, non-infringement and merchantability.

Statements regarding the suitability of products for certain types of applications are based on Din-Tek's knowledge of typical requirements that are often placed on Din-Tek products in generic applications. Such statements are not binding statements about the suitability of products for a particular application. It is the customer's responsibility to validate that a particular product with the properties described in the product specification is suitable for use in a particular application. Parameters provided in datasheets and/or specifications may vary in different applications and performance may vary over time. All operating parameters, including typical parameters, must be validated for each customer application by the customer's technical experts. Product specifications do not expand or otherwise modify Din-Tek's terms and conditions of purchase, including but not limited to the warranty expressed therein.

Except as expressly indicated in writing, Din-Tek products are not designed for use in medical, life-saving, or life-sustaining applications or for any other application in which the failure of the Din-Tek product could result in personal injury or death. Customers using or selling Din-Tek products not expressly indicated for use in such applications do so at their own risk. Please contact authorized Din-Tek personnel to obtain written terms and conditions regarding products designed for such applications.

No license, express or implied, by estoppel or otherwise, to any intellectual property rights is granted by this document or by any conduct of Din-Tek. Product names and markings noted herein may be trademarks of their respective owners.

Material Category Policy

Din-Tek Intertechnology, Inc. hereby certifies that all its products that are identified as RoHS-Compliant fulfill the definitions and restrictions defined under Directive 2011/65/EU of The European Parliament and of the Council of June 8, 2011 on the restriction of the use of certain hazardous substances in electrical and electronic equipment (EEE) - recast, unless otherwise specified as non-compliant.

Please note that some Din-Tek documentation may still make reference to RoHS Directive 2002/95/EC. We confirm that all the products identified as being compliant to Directive 2002/95/EC conform to Directive 2011/65/EU.

Din-Tek Intertechnology, Inc. hereby certifies that all its products that are identified as Halogen-Free follow Halogen-Free requirements as per JEDEC JS709A standards. Please note that some Din-Tek documentation may still make reference to the IEC 61249-2-21 definition. We confirm that all the products identified as being compliant to IEC 61249-2-21 conform to JEDEC JS709A standards.